

# Masport®

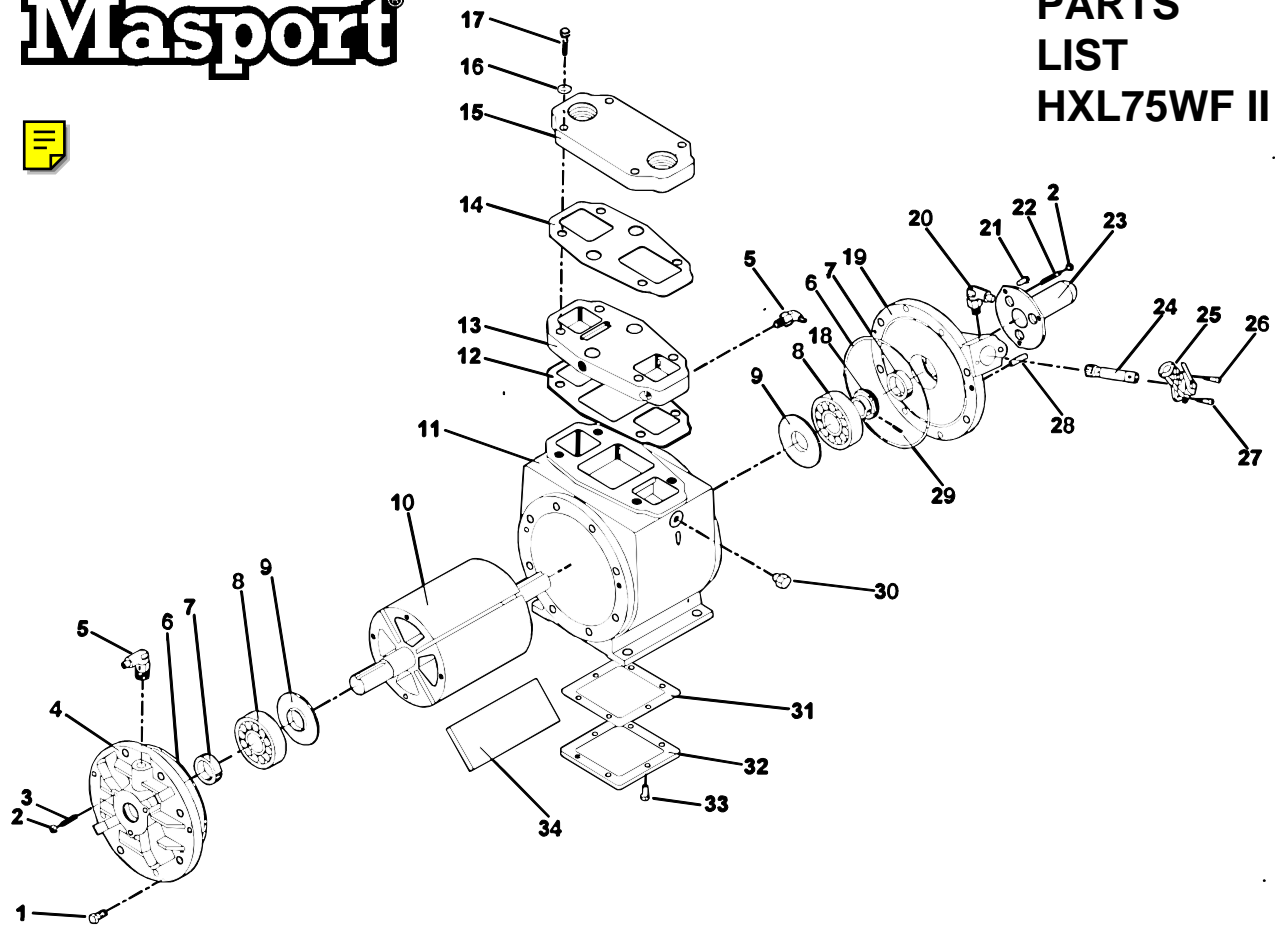

## PARTS LIST HXL75WF II



### HXL75WF SERIES II LIQUID COOLED PRESSURE / VACUUM PUMP PARTS LIST (968680)

Ref	Description	Part No.	Qty.	Ref	Description	Part No.	Qty.
1	Bolt	501569	16	19	Endcover 2-Start	968853	1
2	Nut	504278	6		6-Start	968854	1
3	Set Screw	504276	3	20	Swivel Elbow *	568085	1
4	Endcover	968843	1	21	Bolt	501571	3
5	Swivel Elbow *	568086	3	22	Set Screw	504277	3
6	O-Ring	501677	2	23	Shaft Guard	568622	1
7	Oil Seal	501015	2	24	Drive Shaft Assembly	968045	1
8	Bearing	503098	2	25	Oil Pump	575437	1
9	Bearing Spacer	968611	2	26	Cap Screw	504262	1
10	Rotor Assembly (Incl. 8, 9)			27	Cap Screw	504261	1
	2-Start (Serial # < 91451)	968668	1	28	Dowel Pin	503258	4
	6-Start (Serial # > 91450)	968614	1	29	Set Screw	504264	1
11	Cylinder	968712	1	30	Plug	503416	1
12	Gasket	568703	1	31	Gasket	568708	1
13	Adaptor Plate	968011	1	32	Inspection Plate	968707	1
14	Gasket	568653	1	33	Bolt (Inspection Plate)	501571	6
15	Flange Plate	968706	1	34	Vane	975402	4
16	Washer	500203	4	35	Endcover Shim Gasket **		
17	Bolt	502024	4		.002" Thickness	542011	***
18	Gear 2-Start	575439	1		.003" Thickness	542012	***
	6-Start	568158	1	36	Oil Line (ft.) **	600293	***

\* NOTE: #5 - 975018 and #20 - 975019 CHECK VALVES USED ON EARLIER MODELS ONLY.

\*\* NOT SHOWN.

\*\*\* QUANTITY VARIES.