

---

# EXHAUST INTERCEPTOR

OWNER/ OPERATOR MANUAL



# PLUMBING REQUIREMENTS

## PIPE RECOMMENDATIONS

The Masport Exhaust Interceptor comes in three standard porting sizes ( 1 1/2", 2", and 2 1/2" N.P.T.) to accommodate pumps up to 400 SCFM. Note that some type of pipe sealer should be used on the threads of all pipe fittings to prevent leaks. "LOCTITE" Pipe Sealer With Teflon has proven to be the easiest and most effective product Masport has tested. Teflon Tape should not be used as pieces of the tape can be drawn into the pump and cause vanes to stick.

Also, make certain that all fittings used in the installation of the pumping system are free from metal chips sometimes left in the fitting when it is produced. These chips can cause considerable damage to the pump on initial start up if allowed to remain in the system. Also, this would be a good time to check all the plumbing and plugs, making sure they are all tight and leak proof.

## HOSE SIZE AND TYPE

The hose between the pump, the accessories, and the tank should be no smaller than the pump porting. Using a smaller hose than pump porting will restrict the airflow of the vacuum pump.

When selecting the type of hose to use, keep in mind that Masport Pumps are capable of up to 28" Hg and 30 PSIG. It is therefore important to select an interconnecting hose rated for full vacuum service and adequate pressure, such as a black rubber hose with wire reinforcement.

# PUMP PROTECTION

Masport's Exhaust Interceptor, eliminates smoke, oil carry over and greatly reduces average vacuum pump exhaust noise. Also, the highly efficient Interceptor design captures exhausted oil, eliminating job site mess and clean up. When the vacuum pump operates in the pressure mode, the Exhaust Interceptor functions as a filter preventing foreign particles and dust from entering the pump.

The interceptor is installed on the exhaust side of the pump (See Installation Diagram 1), and provides minimal back pressure.

## **INSTALLATION DIAGRAM 1**

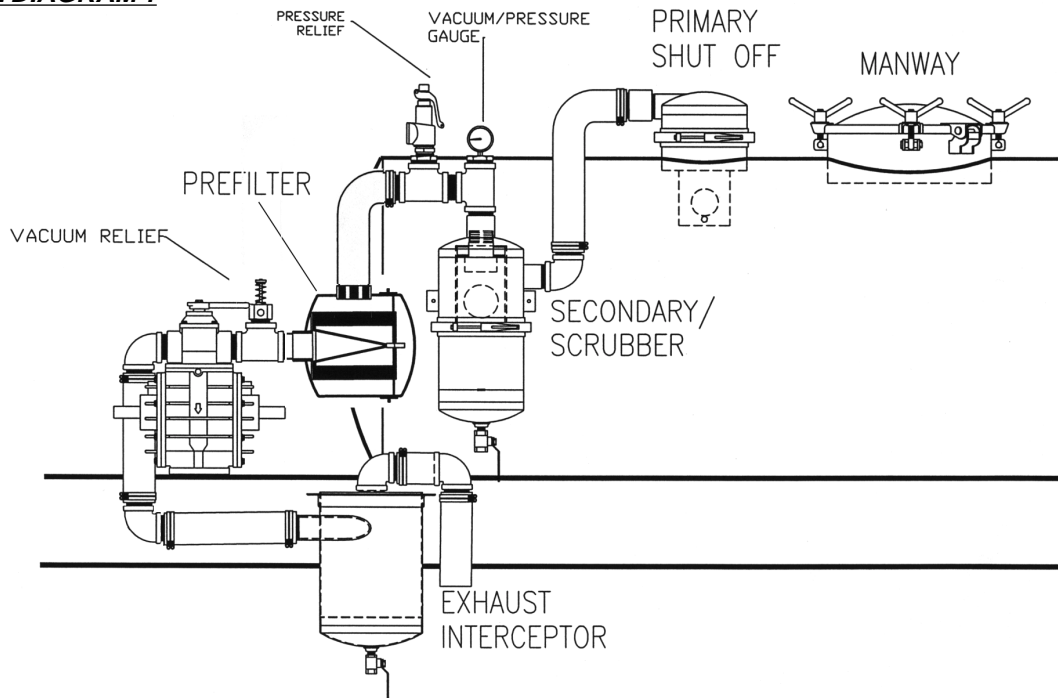

## **FILTER ELEMENT FEATURES AND MAINTENANCE**

Masport's Exhaust Interceptor filter needs replacement when the pressure gauge located on the lid shows a pressure 3 PSIG greater than when it was first installed. Installation diagram 2 (page 3) illustrates the gauge on the lid, and the set up of the oil line to the pump.

To remove the filter element, release the wing nuts and gently lift the lid and cage. After removing the cage, remove the filter element retainer plate by removing the bolt that keeps it in place. (See photos below.) Replace the filter with a new one.

### **FILTER REMOVAL**



1. Release wingnuts A
2. Remove lid with cage B



3. Remove bolt C
4. Remove retainer plate D



5. Replace filter element with new one E

**INSTALLATION DIAGRAM 2**

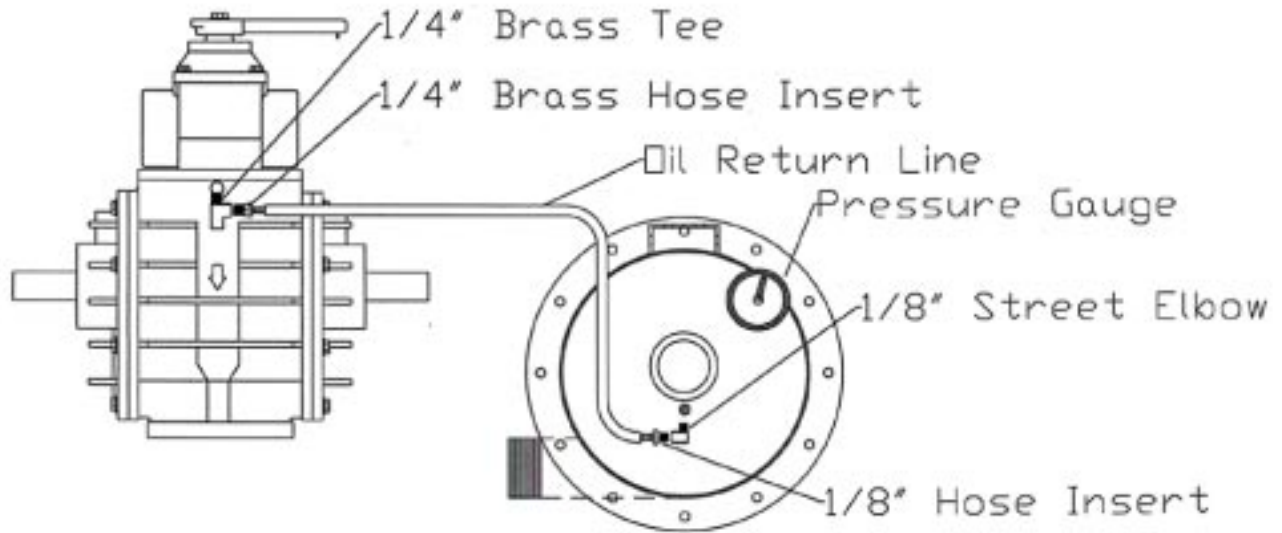

1. Remove oil line elbow to cylinder
2. Install 1/4" Brass Tee and 1/4" Hose Insert in cylinder
3. Replace oil line elbow into open port on Brass Tee.

**DIMENSIONAL DATA**

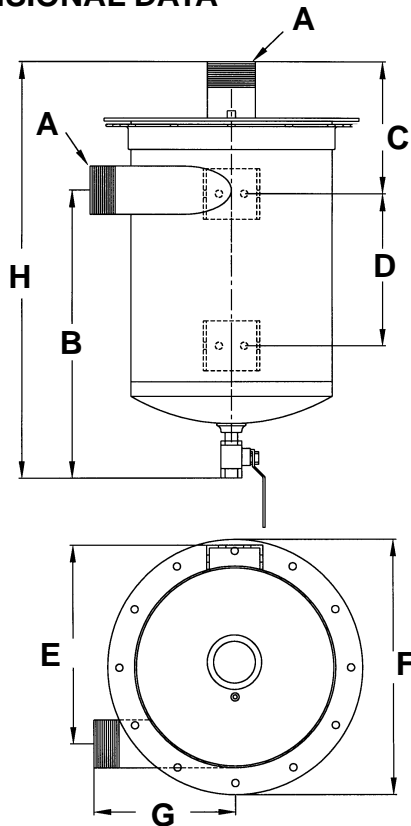

EXHAUST INTERCEPTOR			
	13104	13105	13106
A	1 1/2"	2"	2 1/2"
B	12 7/16"	17 1/16"	17 1/16"
C	5 1/16"	8 7/8"	8 7/8"
D	5 1/2"	8	8
E	10 1/4"	11 13/16"	11 13/16"
F	12 5/8"	15 3/16"	15 3/16"
G	7 11/16"	8 7/16"	8 7/16"
H	17 1/2"	24 11/16"	24 11/16"
weight	42	65	67

REPLACEMENT FILTER ELEMENTS:	
26310	1 1/2" Exhaust Interceptor
26311	2" Exhaust Interceptor
26311	2 1/2" Exhaust Interceptor

**Limited Warranty**

MASPORT warranties against defects in workmanship or parts for 12 months after delivery. The warranty does not cover damage that results from improper installation or for operation beyond capacities specified by MASPORT at date of shipment. Warranty is limited to repair or replacement of parts or components. It is further limited to exclude any contingent liabilities for damage resulting from product failure.

**MASPORT INCORPORATED**

6140 McCormick Drive  
 Lincoln, Nebraska 68507  
 402-466-8428 FAX: 402-466-8355  
 E-Mail: MASPORT@NAVIX.NET  
**CALL TOLL FREE 800-228-4510**