

## Vacuum Truck Components

# Masport® Manways and Port Holes



### ◆ Lid Mounted Nitrile Gasket

- Minimizes Material Build-up on Sealing Faces.
- One Piece Design Offers Superior Stiffness.
- Nitrile Gasket Resists Cutting and Splitting.

### ◆ Wing Nuts

- Made from Ductile Iron for improved durability.
- Easier Opening and Closing by Hand.
- Positive Lock for Lid-to-Collar Alignment and Safety.
- Captive Wear Washer Eliminates Lid Closure Bracket Wear.

### ◆ Hinge and Closure Bracket

- Heavy Duty Hinges, Fitted with Large Diameter Hinge Pins, Allow for Ease of Opening and Closing.
- One Piece Gusseted Bracket Design Provides Even Load Distribution Between Closure Points for Superior Strength and Seal.

### ◆ Masport Quality and Performance

- MIG Welded to Close Tolerances.
- Weld Collar: 1/4" Thick Hot Rolled Steel.
- Zinc Plated, Forged Eye Bolts, hinge pins and Ductile Iron Wing Nuts provide Superior Strength, Corrosion and Rust Resistance.
- High Quality Fit and Finish.

---

# Masport®

# SPECIFICATIONS

ASSEMBLY NUMBER	16202	16202-1	16203	16203-1	16204	16204-1	16205	16205-1
Weld Collar Diameter - O.D."	19 1/4	19 1/4	25 1/4	25 1/4	21 1/4	21 1/4	35 1/4	35 1/4
Net Collar Height	3 1/2	9 1/2	5 7/16	9 7/16	3 1/2	9 1/2	19 1/4	19 1/4
Total Collar Height	6	12	8	12	6	12	8	12
Lid Thickness - inches	3/16	3/16	3/16	3/16	3/16	3/16	3/16	3/16
Material	Hot Rolled Steel		Hot Rolled Steel		Hot Rolled Steel		Hot Rolled Steel	
Standard Gasket Material	Nitrile	Nitrile	Nitrile	Nitrile	Nitrile	Nitrile	Nitrile	Nitrile
Number of Closures	4	4	5	5	5	5	8	8
Working Pressure - Max. P.S.I.	15	15	15	15	15	15	15	15
Net Weight - Lbs.	60	88	98	124	71	97	167	198

# DIMENSIONAL DATA

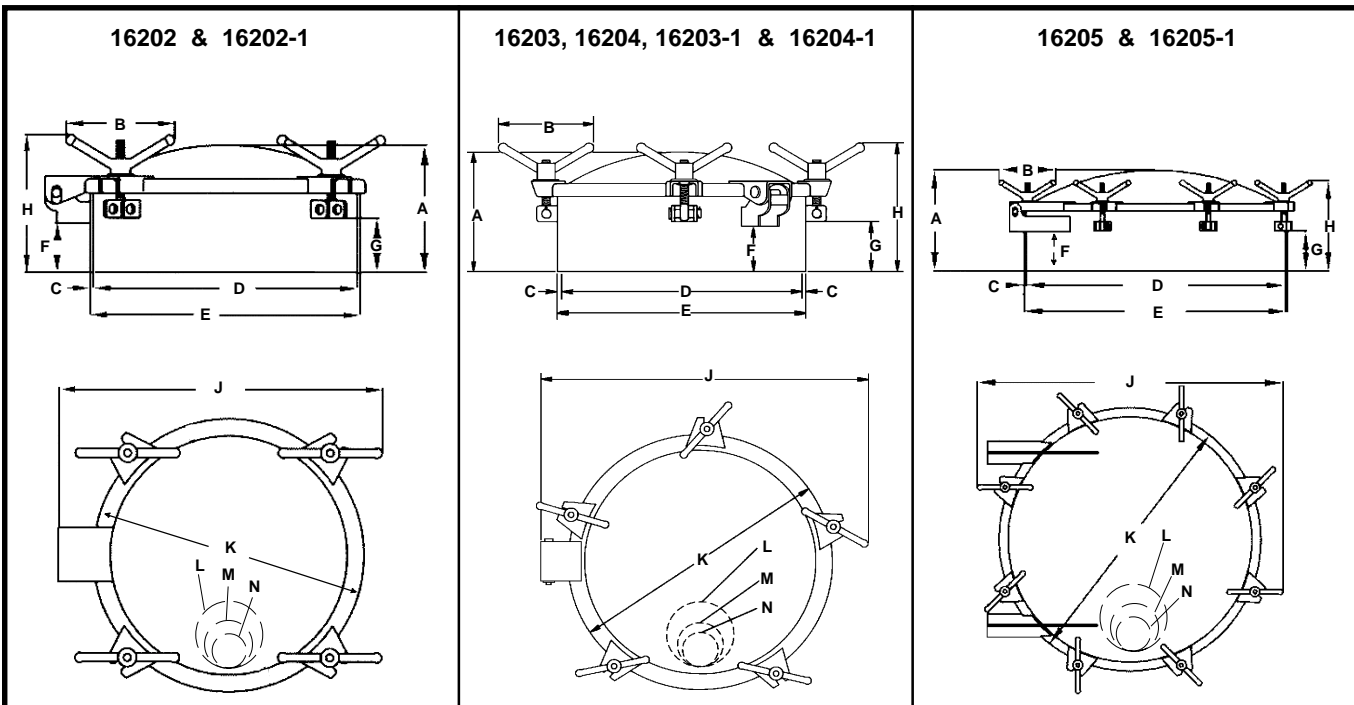

Part #	A	B	C	D	E	F	G	H	J	K	L	M	N
16202	9 1/4	7 1/2	1/4	18 3/4	19 1/4	3 1/2	3 7/8	9 5/16	23 1/2	20	6	4	3
16202-1	15 1/4	7 1/2	1/4	18 3/4	19 1/4	9 1/2	9 7/8	15 5/16	23 1/2	20	6	4	3
16203	12	7 1/2	1/4	24 3/4	25 1/4	5 7/16	5 1/4	11 15/16	33	26	6	4	3
16203-1	16	7 1/2	1/4	24 3/4	25 1/4	9 7/16	9 1/4	15 15/16	33	26	6	4	3
16204	9	7 1/2	1/4	20 3/4	21 1/4	3 1/2	3 7/8	9 5/16	28 11/16	22	6	4	3
16204-1	15	7 1/2	1/4	20 3/4	21 1/4	9 1/2	9 7/8	15 5/16	28 11/16	22	6	4	3
16205	13 1/4	7 1/2	1/4	34 3/4	35 1/4	5 3/16	5 3/16	11 15/16	40 11/16	36	6	4	3
16205-1	17 1/4	7 1/2	1/4	34 3/4	35 1/4	9 3/16	9 3/16	15 15/16	40 11/16	36	6	4	3

ALL DIMENSIONS IN INCHES. DIMENSIONS 'L', 'M' AND 'N' REPRESENT NOMINAL PIPE DIAMETER.

For additional information on this  
Quality Masport Manway contact:

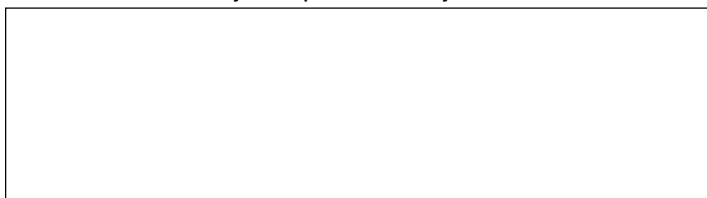

## MASPORT INCORPORATED

6140 McCormick Drive  
Lincoln, Nebraska 68507  
402-466-8428 FAX: 402-466-8355  
E-Mail: MASPORT@NAVIX.NET  
CALL TOLL FREE 800-228-4510

